

TECHNISCHE DATEN:

Aufbau

| | |
|--------------------|---------------------------------------|
| Hutmutter | Messing CuZn39Pb3, galv. vernickelt |
| Staubschutzscheibe | Polyethylen PE-LD |
| Lamelleneinsatz | Polyamid PA6 |
| Dichtring | Polychloropren-Nitrilkautschuk CR/NBR |
| Zwischenstutzen | Messing CuZn39Pb3, galv. vernickelt |
| O-Ring | Nitrilkautschuk NBR |
| Anschlussgewinde | metrisch, nach EN 60423 |

Eigenschaften

- großer Dicht- und Klemmbereich
- montagefreundlich

| | | |
|----------------------|--|-----------------|
| Gruppe (Zone) | II 2 G (1, 2) | II 2 D (21, 22) |
| Kennzeichnung | Ex eb IIC Gb | Ex tb IIIC Db |
| Kabelverlegung | festverlegt | |
| Temperaturbereich | -40 °C / +85 °C | |
| Schutzart | IP66 / IP68 - 10 bar (30 min.) | |
| Prüfnorm | EN IEC 60079-0:2018, IEC 60079-0:2017 EN IEC 60079-7:2015+A1, IEC 60079-7:2017 EN 60079-31:2014, IEC 60079-31:2022 | |
| EU-Prüfbescheinigung | BVS 17 ATEX E 118 X | |
| IECEX-Zertifikat | IECEX BVS 17.0101X | |

TECHNICAL DATA:

Configuration

| | |
|-------------------|---------------------------------------|
| Dome nut | Brass CuZn39Pb3, nickel-plated |
| Dust cap | Polyethylene PE-LD |
| Lamellar insert | Polyamide PA6 |
| Sealing ring | Polychloroprene-Nitrile rubber CR/NBR |
| Gland body | Brass CuZn39Pb3, nickel-plated |
| O-ring | Nitrile rubber NBR |
| Connecting thread | metric, as per EN 60423 |

Properties

- wide sealing and clamping range
- easy-to-install

| | | |
|---------------------|--|-----------------|
| Group (Zone) | II 2 G (1, 2) | II 2 D (21, 22) |
| Marking | Ex eb IIC Gb | Ex tb IIIC Db |
| Cable installation | fixed | |
| Temperature range | -40 °C / +85 °C | |
| Protection grade | IP66 / IP68 - 10 bar (30 min.) | |
| Test standard | EN IEC 60079-0:2018, IEC 60079-0:2017 EN IEC 60079-7:2015+A1, IEC 60079-7:2017 EN 60079-31:2014, IEC 60079-31:2022 | |
| EU-Type certificate | BVS 17 ATEX E 118 X | |
| IECEX-Certificate | IECEX BVS 17.0101X | |

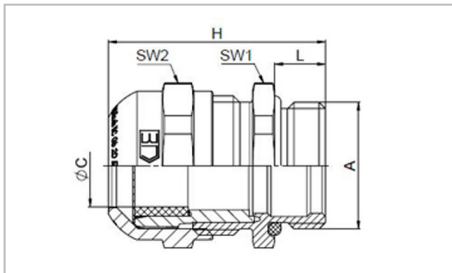

Merkmale

Characteristics

Anschlussgewinde Standardlänge

Connecting thread standard length

| A | ØC mm | $\frac{E_{mm}}{L}$ mm | SW1 mm | SW2 mm | H mm |  | Art.-Nr. / Part No. |
|---------|----------|--------------------------|-----------|-----------|---------|---|---------------------|
| M12x1,5 | 3 - 7 | 6,5 | 16 | 16 | 28 | 100 | K100-1012-00-EX |
| M16x1,5 | 6 - 10 | 7 | 20 | 20 | 33 | 100 | K100-1016-00-EX |
| M20x1,5 | 8 - 13 | 8 | 24 | 24 | 34 | 50 | K100-1020-00-EX |
| M25x1,5 | 10 - 17 | 8 | 29 | 29 | 37,5 | 50 | K100-1025-00-EX |
| M32x1,5 | 11 - 21 | 9 | 36 | 36 | 47,5 | 25 | K100-1032-00-EX |
| M40x1,5 | 16 - 28 | 9 | 45 | 45 | 53,5 | 10 | K100-1040-00-EX |
| M50x1,5 | 21 - 35 | 10 | 55 | 55 | 62 | 5 | K100-1050-00-EX |
| M63x1,5 | 34 - 48 | 10 | 68 | 68 | 63 | 5 | K100-1063-00-EX |

Anschlussgewinde lang

Connecting thread long

| A | ØC mm | $\frac{E_{mm}}{L}$ mm | SW1 mm | SW2 mm | H mm |  | Art.-Nr. / Part No. |
|---------|----------|--------------------------|-----------|-----------|---------|---|---------------------|
| M12x1,5 | 3 - 7 | 12 | 16 | 16 | 33,5 | 100 | K100-1012-50-EX |
| M16x1,5 | 6 - 10 | 12 | 20 | 20 | 38 | 100 | K100-1016-50-EX |
| M20x1,5 | 8 - 13 | 13 | 24 | 24 | 39 | 50 | K100-1020-50-EX |
| M25x1,5 | 10 - 17 | 13 | 29 | 29 | 42,5 | 50 | K100-1025-50-EX |
| M32x1,5 | 11 - 21 | 14 | 36 | 36 | 52,5 | 25 | K100-1032-50-EX |
| M40x1,5 | 16 - 28 | 14 | 45 | 45 | 58,5 | 10 | K100-1040-50-EX |
| M50x1,5 | 21 - 35 | 15 | 55 | 55 | 67 | 5 | K100-1050-50-EX |
| M63x1,5 | 34 - 48 | 15 | 68 | 68 | 68 | 5 | K100-1063-50-EX |