



5HE 7TAKT DUO



TYPICAL APPLICATIONS	Hobs control
WIRING DIAGRAMAS	7 positions
GWFI	850 °C
GWT NO FLAME (<2sec)	750 °C

This series is composed of two 5HE 7TAKT rotary selectors, 3 different distances of axis available (55, 60 and 65 mm). Each selector has 7 positions, electric rating up to 12A and different mounting solutions. Duo block permits to make the wiring easier.

- Standard connecting with single terminals 6,3 m
- Different mounting solutions available: snap-in, nuts or central mounting
- Metal or plastic shafts with different lengths
- Rast 6,5 multiple connection available
- Metal or plastic shafts with different lengths: (16 - 31 mm)

EXAMPLE OF 5HE 7TAKT DUO WITH NUTS

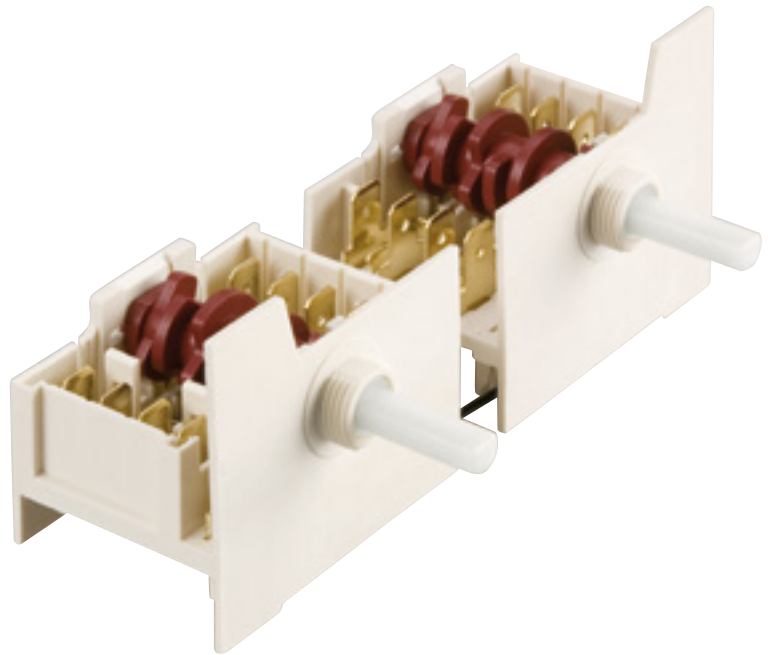

RATING

12 A / 400 VAC 30E3
T150 °C
 According to EN 61058-1

16 A / 250 VAC
 T120 °C
 According to UL 61058-1

TECHNICAL FEATURES

Various distances of axis available: 55, 60 and 65 mm.

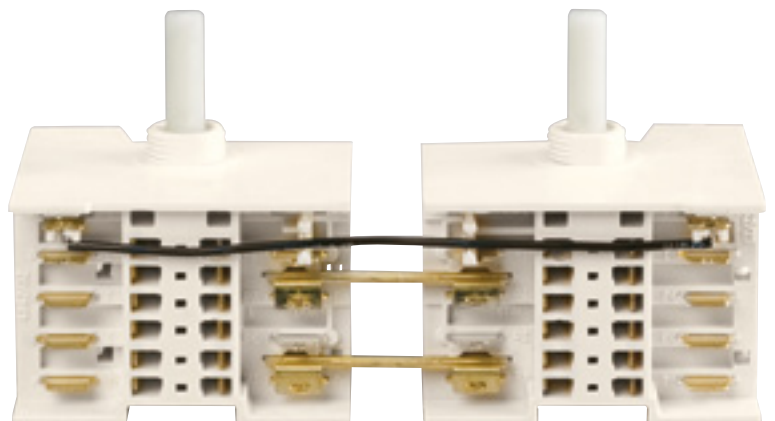

DIMENSIONS

Screw fixing version

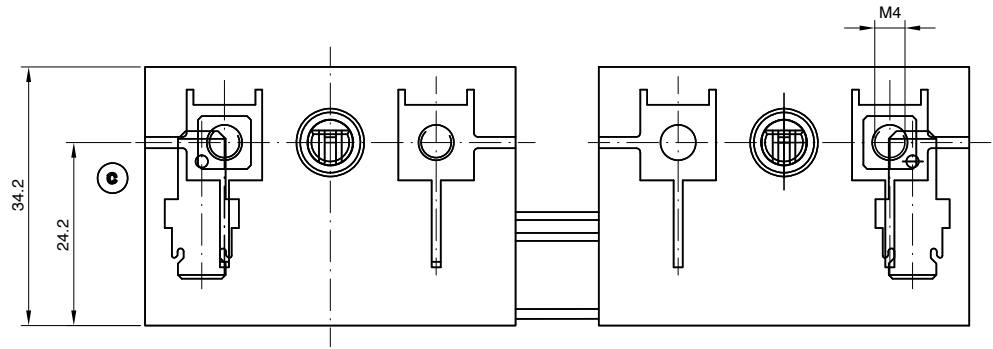

60 mm interaxis version
(55 and 65 mm available)

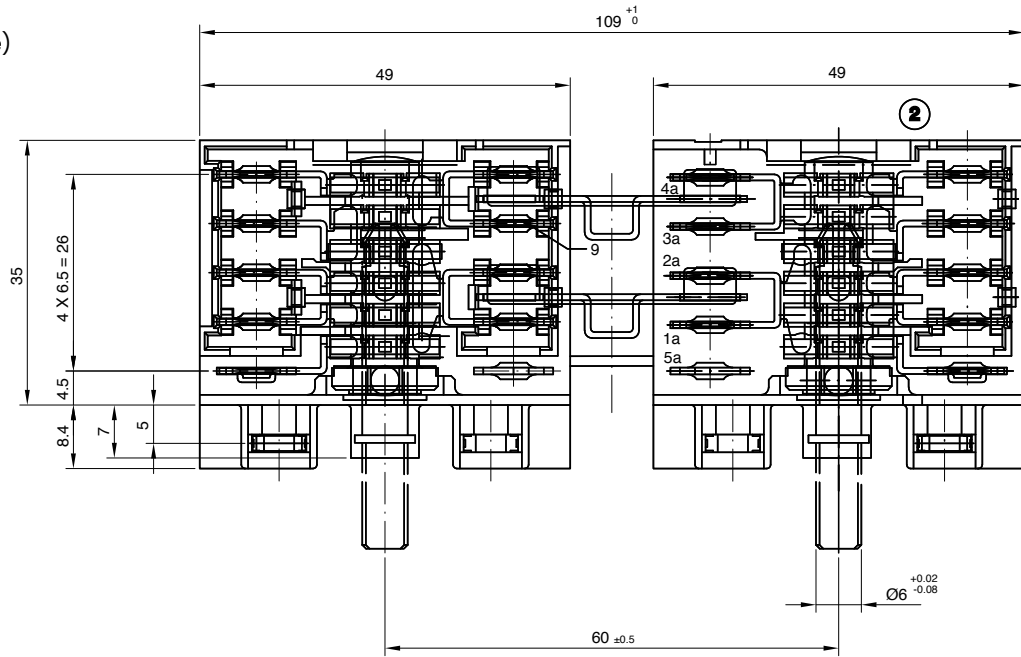

CONTACT SEQUENCE

Pos.	Ang.	P3		P1		P2		Pos.	Ang.	5a		1a-2a		3a-4a	
		S	5a	1	2	3-3	4			S	5a	1	2	3-3	4
0	0°							0	0°						
1	51,4°	■	■	■				1	51,4°	■	■	■		■	■
2	102,8°	■		■				2	102,8°	■		■		■	■
3	154,2°	■		■				3	154,2°	■		■		■	
4	205,6°	■		■				4	205,6°	■		■			■
5	257,0°	■				■		5	257,0°	■			■		■
6	308,4°	■	■					6	308,4°	■	■				■