

Ø 10mm

TB/010/SC

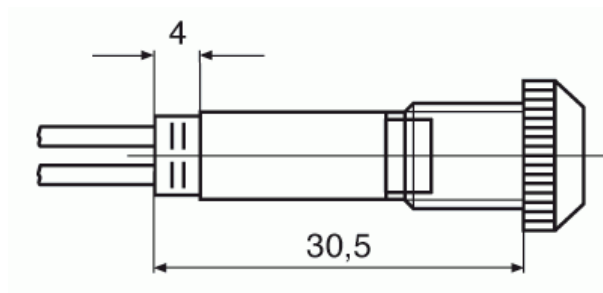

Screw locking light indicator.

There is the opportunity to request the lens and the screw assembled or apart (not assembled on the plastic case).

Working voltage	6V ; 12V ; 24V ; 48V ; 110V ; 250V ; 400V
Max temperature	90°C ; 120°C ; 150°C
Hole diameter	10mm +0,2-0
Panel thickness	from 0,5mm to 5mm
Way of locking on the panel	with screw
Lamp type	incandescent lamp ; neon/fluorescent lamp ; LED lamp lamp
Connection way	pvc cable ; silicon cable ; silicon-glass cable
Wire ends	on request
Lens type	suitable for a 10mm hole (lens type: SC)
Lens – case connection	fixed ; extractable
Approvals	VDE - UL/CSA - CE