



Push-button switches



SP63 Series

Square cut out - 27X22
ENEC electrical rating up to 16A

- Wiring diagrams flexibility
- Illuminated or not
- Independent light version available
- Applications: vacuum and steam cleaners

Products

Customising on demand

Accessories

Electrical features

ENEC electrical rating up to	16A
Electro-mechanical cycles number up to	50.000
Room temperature up to	120 °C
Flammability	UL 94 V2
Heat and fire resistance	GWFI 850 °C
	GWIT 750 °C on demand
Contact gap	≥ 3 mm
Approvals available (to check according to the rating of each single material code)	
Reference standards	EN 61058 UL 1054

Wiring diagrams

- Illuminated double-pole switch dependent light
- Illuminated single-pole momentary switch independent light
- Single-pole momentary switch
- Single-pole switch

Cut out (mm)

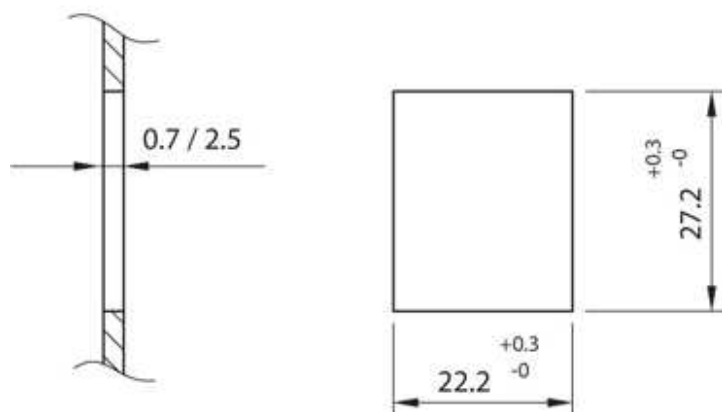

Stampa scheda