

Signalling various units

2T

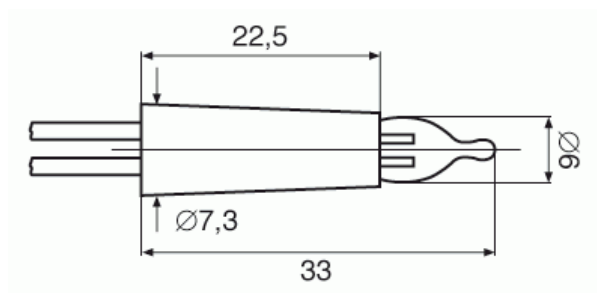

Light indicator with conical case.

Working voltage

6V ; 12V ; 24V ; 48V ; 110V ; 250V ; 400V

Max temperature

90°C ; 120°C ; 150°C

Lamp type

incandescent lamp ; neon/fluorescent lamp ; LED lamp lamp

Connection way

pvc cable ; silicon cable ; silicon-glass cable

Wire ends

on request

Approvals

CE